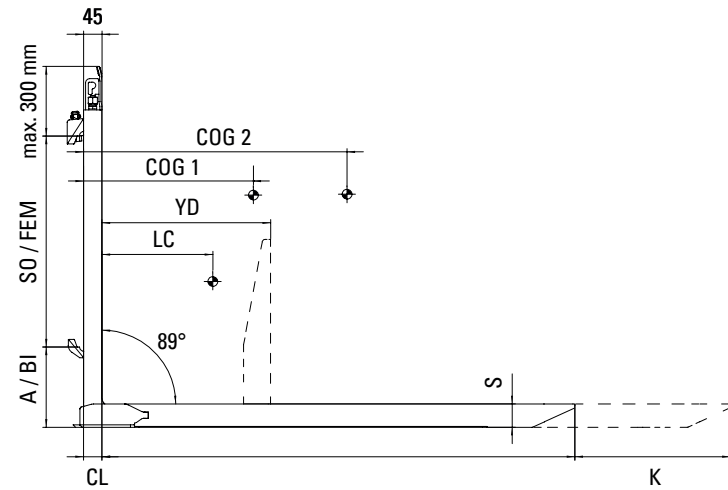
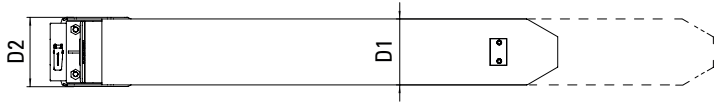

ReachForks for ReachForks for Single-Double Attachments

MAIN SPECIFICATIONS

Recommended Models

Model	Capacity on LC 600 (mm)	Section D1/D2xS (±mm)	L/K (±mm)	C (±mm)	CoG1h (±mm)	CoG2h (±mm)	CoGv (±mm)	Weight pair (kg)	ISO/FEM	Palletstops YD-Y2 (±mm)	Pallet Behind Each	
RE2 27 0800/0400	2700	81/89x63	0800/0400	60	258	343	131	84	551	0800/1200	-	-
RE2 27 1025/0575		81/89x63	1025/0575	60	351	483	115	99		-	0800+0800	-
RE2 27 1225/0775		81/89x63	1225/0775	60	437	628	105	112		-	1000+1000	-
RE2 27 1425/0975		81/89x63	1425/0975	60	516	798	92	130		-	-	1200+1200
RG4 35 1350/1000	3700	81/89x73	0800/0400	60	441	699	125	225	551	0800/1200	-	-
RG4 35 1400/1000		81/89x73	1025/0575	60	471	702	127	224		-	0800+0800	-
RG4 45 1350/1000		81/89x73	1225/0775	60	441	699	125	225		-	1000+1000	-
RG4 45 1400/1000		81/89x73	1425/0975	60	471	702	127	224		-	-	1200+1200

Technical features:

- Each of the two ReachForks has one cylinder, providing a high working speed with sufficient pulling and pushing force.
- Retracted length, stroke length and suspension can be customer specific. The most common ReachForks are listed below.
- A minimum working pressure of 160 bar and a maximum of 250 bar is required for the proper functioning of the ReachForks
- Too many hydraulic liters (flow) results in unnecessary heat and energy loss. Optimally, ReachForks function with a flow of 12-25 l/min.
- All ReachForks with model indication RG have an integrated equalizing valve, making a "flow divider" unnecessary.
- For optimal operation of the ReachForks, a passage of hydraulic components such as hoses and couplings require a minimum passage of 8 mm.
- The models marked RGN are slightly thicker (higher) than the RG models but have less deflection.
- RG models are mounted in series according to the hydraulic diagram.
- The ReachForks are guaranteed to be used in cold stores up to a maximum temperature of minus 30 degrees celsius.
- The capacity of each ReachFork is engraved in the fork back and on the nameplate. The capacity of the ReachForks is not the capacity of the forklift.
- The forklift supplier is responsible for the combination forklift and telescopic forks regarding residual capacity and proper assembly.